

Courtyard by Marriott – Seattle North/Lynnwood Everett is conveniently located just off I-5 and south of the I-405 interchange. The hotel is near the Alderwood Mall shopping area.

Accommodations:

- 164 spacious guestrooms including eight king suites and four whirlpool spa rooms
- Standard rooms feature one king or two queen sized beds, oversized work desk with ergonomic chair, voice mail and data ports
- King suites also include separate sitting area with sofa bed
- Whirlpool spa rooms include the same features as standard rooms with a Jacuzzi tub located in the corner of the bedroom – ideal for relaxing while watching television

Amenities Include:

- Complimentary wi-fi Internet access in guest rooms and lobby
- 1,230 square feet of total meeting space
- The Courtyard Bistro – your source for healthy food and beverages offering breakfast, dinner and a full-service bar
- Indoor swimming pool and hydrotherapy spa
- Fitness center featuring the latest cardiovascular equipment, treadmill, elliptical and lifecycle

- Free area shuttle service within 5 miles radius of the hotel on a space available basis
- Complimentary parking
- Valet and guest laundry
- Business services including fax and copy service, WIFI and printer usage

Meeting Space:

- 3 meeting rooms, amounting in 1,230 square feet of flexible meeting space for up to 50 people as well as catering services
- Largest meeting room is Glacier with a maximum meeting space of 690 square feet and maximum seating capacity of 50
- Corporate conference suites offer additional space for smaller business meetings
- Business travelers at our North Seattle hotel will enjoy our full-service business center



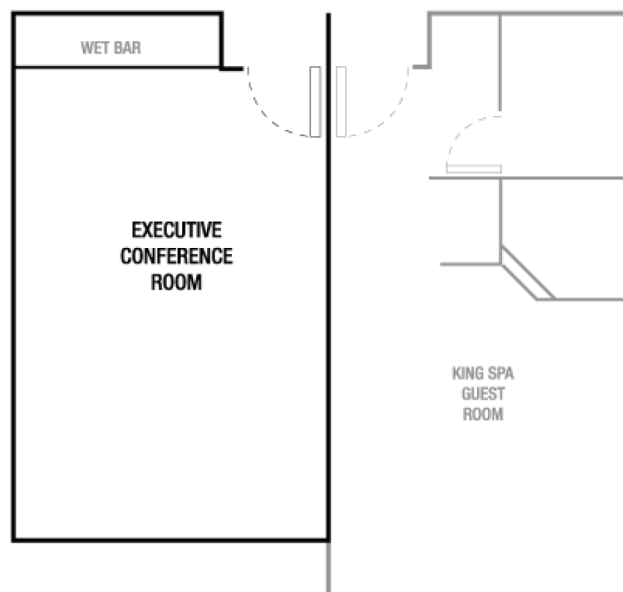
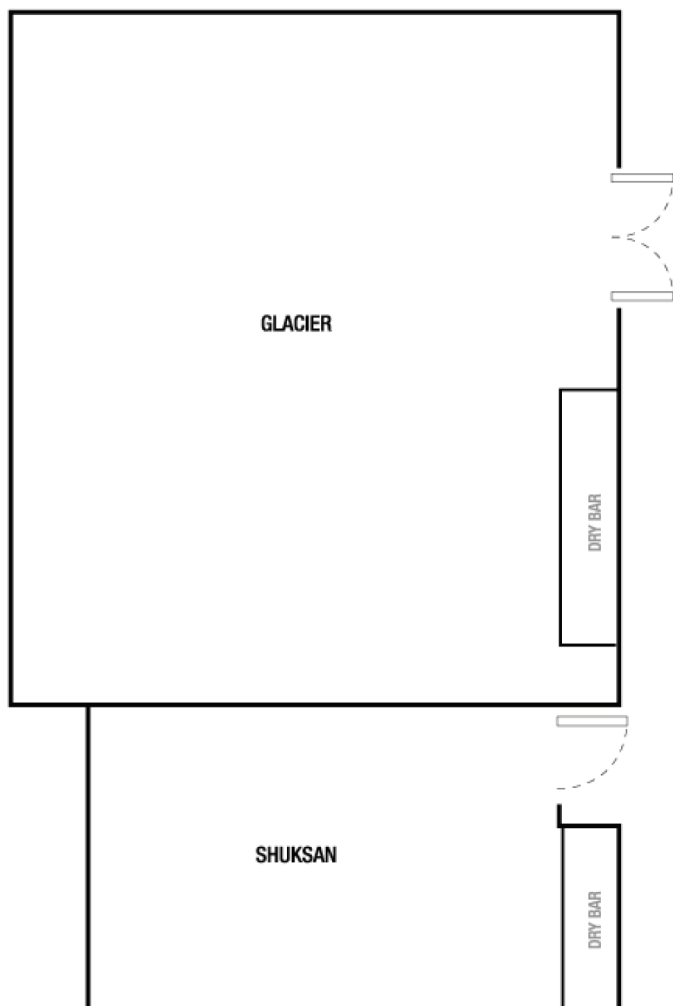

ROOM	DIMENSION	SQ. FT.	CEILING HEIGHT	THEATER	RECEPTION	BANQUET	CLASSROOM
Glacier	30' x 23'	690	N/A	50	50	50	45
Shuksan	12' x 20'	240	N/A	20	25	20	15
Summit/Executive Conference Room	23' x 13'	299	N/A	18	25	18	15